



**ASCA Sanction Pending**

## **UMASC Pine County Corn Classic & Old Timer's Parade** **May 25-27, 2013**

**\*All Breeds Welcome\***



**STOCK NOTE:** 5 head of Khaki Campbell drakes for all duck runs. Sheep will be a mixture of hair/wool/ and lambs. Stock trials will be 3-5 head. Farm trial will be 8 head. Ranch trial will be 10 head.

<b>SATURDAY May 25th</b>	<b>Available Runs</b>	<b>Course/ Arena</b>	<b>Judge</b>	
<b>A.M. Stock Trial</b>  Check In/ Day of Entries: 7:30 a.m. - 7:45 a.m.	20 - Sheep  20 - Ducks	Sheep - Course A 200' x 350' arena  Ducks - Course A 100' x 100' arena	James Bergert	<ul style="list-style-type: none"> <li>• Handler's meeting 8:00 a.m.</li> <li>• Trial to start immediately after Handler's Meeting</li> </ul>
<b>P.M. Farm Trial</b>  Check In/ Day of Entries: 7:30 a.m. – end of A.M. trial	9 - Sheep	Course description available in flyer	Bob Myrick	<ul style="list-style-type: none"> <li>• Handler's meeting will start after completion of A.M. trial.</li> </ul>

<b>SUNDAY May 26th</b>	<b>Available Runs</b>	<b>Course/ Arena</b>	<b>Judge</b>	
<b>A.M. Stock Trial</b>  Check In/ Day of Entries: 7:30 a.m. – 7:45 a.m.	20 - Sheep  20 - Ducks	Sheep - Course A 200' x 350' arena  Ducks - Course B 100' x 100' arena	Bob Myrick	<ul style="list-style-type: none"> <li>• Handler's meeting 8:00 a.m.</li> <li>• Trial to start immediately after Handler's Meeting</li> </ul>



**ASCA Sanction Pending**

**UMASC Pine County Corn Classic & Old Timer's Parade  
May 25-27, 2013**

<b>SUNDAY May 26th</b>	<b>Available Runs</b>	<b>Course/ Arena</b>	<b>Judge</b>	
<b>P.M. Stock Trial</b>  Check In/ Day of Entries: 7:30 a.m. – end of A.M. trial	20 - Sheep  20 - Ducks	Sheep - Course A 200' x 350' arena  Ducks – Course A 100' x 100' arena	James Bergert	<ul style="list-style-type: none"> <li>• Handler's meeting will start immediately after completion of A.M. trial.</li> </ul>
<b>OLD TIMER'S PARADE BEFORE THE P.M. AWARDS</b>				

<b>MONDAY May 27th</b>	<b>Available Runs</b>	<b>Course/ Arena</b>	<b>Judge</b>	
<b>A.M. Stock Trial</b>  Check In/ Day of Entries: 6:45 a.m. -7:00 a.m.	Sheep - 12  Ducks - 12	Sheep - Course B 200' x 350' arena  Ducks – Course B 100' x 100' arena	Bob Myrick	<ul style="list-style-type: none"> <li>• Handler's meeting 7:00 a.m.</li> <li>• Trial to start immediately after Handler's Meeting</li> </ul>
<b>P.M. Ranch Trial</b>  Check In/ Day of Entries: 6:45 a.m. – end of A.M. trial	Sheep - 6	Course description available in flyer	Bob Myrick	<ul style="list-style-type: none"> <li>• Handler's meeting will start after completion of A.M. trial.</li> </ul>

**All pre-entries must be postmarked on or after April 15, 2013 through May 20, 2013.** No pre-entries will be accepted with a postmark before April 15<sup>th</sup>! Sorry, no phone or email entries!

**Please state clearly on entry form which dates/ trials and what classes you are entering.**

All non-aussie entrants must be registered with a tracking number from ASCA to receive titles. See ASCA website for details. You may also register for a tracking number at the trial. [www.asca.org](http://www.asca.org)

Entries will be accepted in postmark order. In the case of duplicate postmark entries a random draw will be made of those entries to determine the order of acceptance. Run order will be drawn on May 24<sup>th</sup>.

**Correct entry fee must accompany an official, signed, and FULLY completed ASCA entry to be considered a valid entry.** Forms are available on the ASCA website. [www.asca.org](http://www.asca.org) Day of show entries will be allowed if space is available. A waiting list will be established if the trial fills. **Entry fees will only be refunded if the trial AND your spot is filled.** Bitches in heat will run in the order of the draw.



**ASCA Sanction Pending**

## **UMASC Pine County Corn Classic & Old Timer's Parade May 25-27, 2013**

Make checks payable to: UMASC

**Send entries to:**

Kim Schneider  
23322 Russell Road  
Pine City, MN 55063

**Course Director:**

Kim Schneider  
cell: 651-332-6778  
email: [hzlbt@aol.com](mailto:hzlbt@aol.com)

**Show Secretary:**

Jodi Ebert

Please include your email address on the entry form and we will confirm that your entry was accepted or if you are on the waiting list. If you do not have email, please enclose a self-addressed stamped postcard.

Entrants are responsible for all damage caused by themselves, their dogs, and their family members. UMASC/& members/& the Schneider family assume no responsibility for any accident, injury, loss or theft. Please stay in the designated areas. Please clean up after your dogs. **DO NOT POTTY OR EXERCISE DOGS ON ANY ONE ELSE'S PROPERTY OTHER THAN THE HOST SITE.** All dogs must be **ON LEASH** at all times. Failure to comply with the above will result in the entrant being asked to leave and no refunds to be given.

Please note ASCA's Bite Incident policy will be strictly enforced if a dog is involved in an altercation with another dog or person.

**Location:** Elysian Farm  
Joe and Kim Schneider  
23322 Russell Road  
Pine City, MN 55063  
Cell: 651-332-6778

Email: [hzlbt@aol.com](mailto:hzlbt@aol.com)

**Directions:** From I-35 North: Take 35 North to Exit 165/County Road 70 (Rock Creek Exit). Head east (right) till you reach the 4 way stop. At the stop take 361 North (left). Follow 361N to County Road 117 /Liberty Road (1.3 mi). Head east (right) on 117/Liberty Road. Follow the road until it stops (2 mi). Head north (left) on County Road 4/Military Road/Government Road. This is a paved road. From County Road 4 head north until you reach Russell Road (.6 mi). Head east (right) on Russell Road. Elysian Farm will be the 3<sup>rd</sup> house on your right (.6 mi). Our driveway is not paved. Please use caution when driving or parking if it is wet out.

Veterinarian on Call: Pine City Veterinary Clinic: 320-629-7591

**Volunteers are needed to help the trials run smoothly. Timers, scorekeepers, stock handlers, runners, are always needed and APPRECIATED! If you would like the trials to continue please help wherever you can when you are not running a dog. Thank you!!!!!!!!!!!!!!**

**There will be a potluck lunch on Saturday and Sunday. More details to follow closer to trial date.**

**We will be taking judges out to dinner on Saturday and Sunday evening. Everyone welcome to join us.**



**ASCA Sanction Pending**

## **UMASC Pine County Corn Classic & Old Timer's Parade May 25-27, 2013**

### **Pre-Entry Fees:**

Sheep: \$30.00  
Ducks: \$20.00  
Sheep Farm/Ranch Trial: \$50.00  
Open Working Junior: Same as above  
Working Junior and Pee-Wees (Ducks only): \$10.00

### **Day of Entry Fees:**

\$35.00  
\$25.00  
\$55.00

### **Awards for each regular stock trial:**

- High in Trial Sheep
- High in Trial Duck
- Most Promising Started Aussie (Highest 2 qualifying scores will be used. If there are not 2 qualifying scores than the highest qualifying score will be used)
- High Working Junior (for each trial)
- High Open Working Junior (for each trial)
- Pee-Wee Participation (for each trial)

### **Special Awards:**

- High in Trial Sheep Farm
- High in Trial Sheep Ranch
- High Combined Non-WTCH Aussie (highest qualifying scores taken from all stock trials)
- High Combined WTCH Aussie (highest qualifying scores taken from all stock trials)
- High Combined Non-Aussie (highest qualifying scores taken from all stock trials)

### **OLD TIMER'S PARADE**

On Sunday, before p.m. stock awards are given out, we will have a special parade of veteran stock dogs. Bring those good ol' boys and girls out to strut their stuff. Special awards to be given out to any dog 10 or older that entered the Sunday Trial. The old timers who join us and supervise verses working will also receive a special award.

If you enter your Old Timer please send a brief bio regarding your dog (i.e. name/ age/ titles/ special chores/ etc....) to be read during the parade.



**ASCA Sanction Pending**

## **UMASC Pine County Corn Classic & Old Timer's Parade May 25-27, 2013**

### **SHEEP FARM TRIAL**

#### **1. Pen Work – 25 points**

8 head of sheep will be put into pen D. Dog and handler will take all head from Pen D and put into Pen E.

#### **2. Location specific task – trailer – 15 points**

- **Open Handler/ Dogs** will put all sheep into stock trailer. They will have a 12 foot wing on the northwest side of trailer.
- **Advanced handler/dogs** will put all sheep into stock trailer. No wing will be used.

#### **3. Gather work – 25 points**

Take stock thru gate 1 and put into 100 x 200 arena. Take sheep to post 3 and settle with a pan of grain.

- **Open handler** may go to Post 2. Dog must stay at Post 1 until sent. Handler will send dog for outrun and bring sheep to Post 1.
- **Advanced handler /dog** will got to Post 1. Handler must stay at post and send dog for outrun and bring sheep to Post 1

#### **4. Chute work – 25 points**

Take stock thru Chute entering thru east end. Mark 3 head of sheep.

#### **5. Location specific task – Hold – 15 points**

Take stock to marked hold area. Stock must be in hold area and settled until judge calls "Hold"

#### **6. Sort work – 25 points**

Take sheep to Gate 2. Put 3 marked head into Pen A. Put 3 unmarked head into Pen B. Put 2 unmarked head into Pen C. Put all 8 sheep back into Pen C. Dog and handler may use any combination of gates and pens to accomplish above. Trial completed when all 8 head are in Pen C and all gates are closed.

- Time limit is 15 minutes, with a 3 minute warning. Open and Advanced Farm trial dogs must earn 70% or more of the total points (91/130) to qualify. Dogs must earn their open farm title before entering the advanced farm trial class.
- Ties will be broken by the sort work score.



**ASCA Sanction Pending**  
**UMASC Pine County Corn Classic & Old Timer's Parade**  
**May 25-27, 2013**

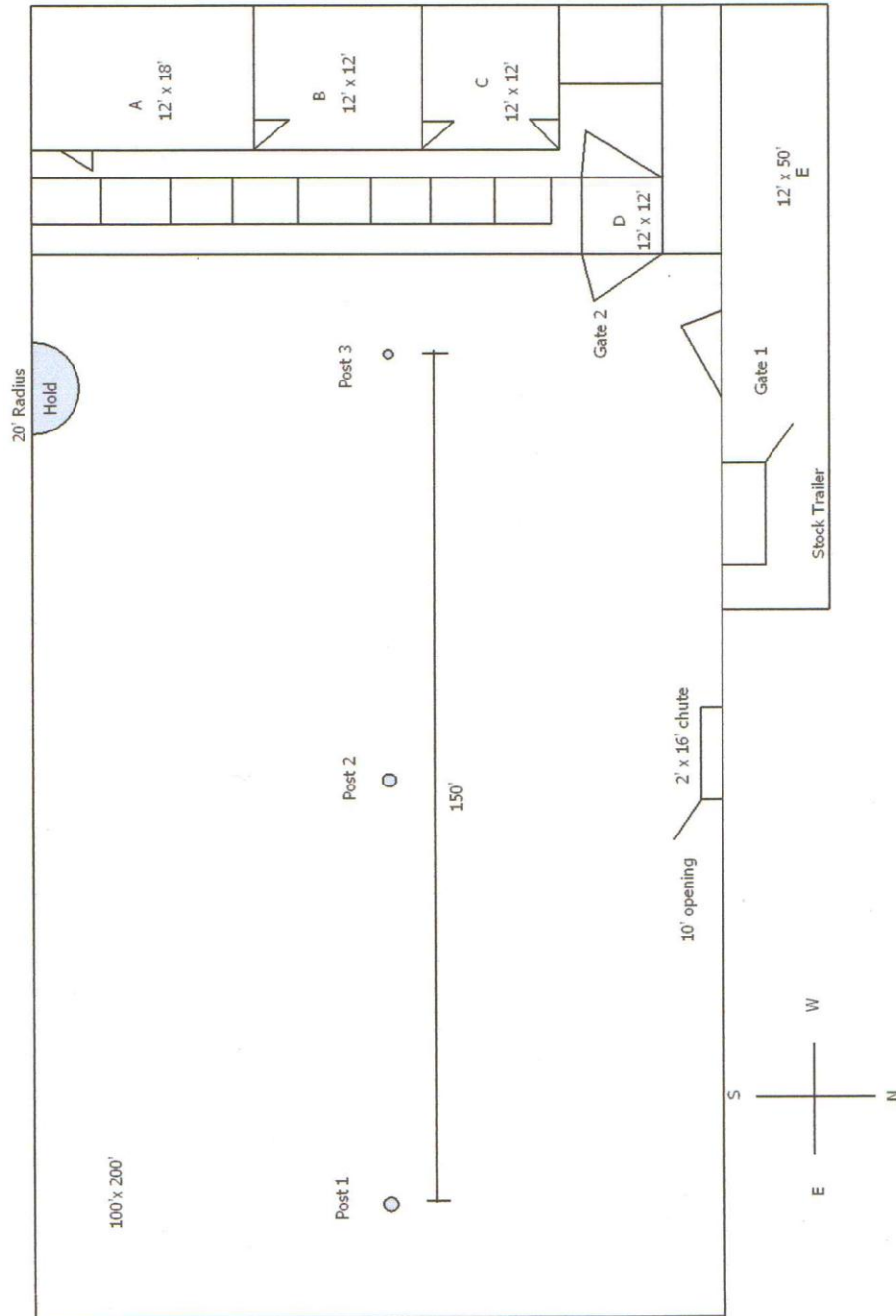



**ASCA Sanction Pending**

## **UMASC Pine County Corn Classic & Old Timer's Parade May 25-27, 2013**

### **SHEEP RANCH TRIAL**

- 1. Pen work – Part A** (Note: a total of 20 points between Part A and Part B)  
Ten head of sheep will start out in Pen A. 3 head will be marked before run starts. Dog and handler will move sheep from Pen A to Pen B.
  - 2. Sort work – 20 points**  
Take 3 marked head of sheep and put into Pen D. Any combination of Pen A, B, C, D, E and Gate 1 may be used to accomplish. Once sheep are sorted, put all sheep back together and put them into pen E.
  - 3. Pasture work – 40 points**  
Take sheep out of Pen E and put into Field F thru Gate 2. Fetch or drive sheep clockwise around perimeter of Field F and past Post Z.
  - 4. Chute work – 20 points**  
Load all head of stock thru chute and into stock trailer. Take stock out of stock trailer
  - 5. Pen work – Part B**  
Take stock thru Gate 3 and Gate 4 and put into Pen G. Ranch trial is completed when all stock are in Pen G and all gates are closed.
- Time limit is 20 minutes, with two warnings (one at 10 minutes and one at 5 minutes).
  - A qualifying score is earned by any dog receiving 75% or more of total score. A dog that has qualified at a Sheep Ranch Trial earns the right to use the title RTDs.



ASCA Sanction Pending

# UMASC Pine County Corn Classic & Old Timer's Parade May 25-27, 2013

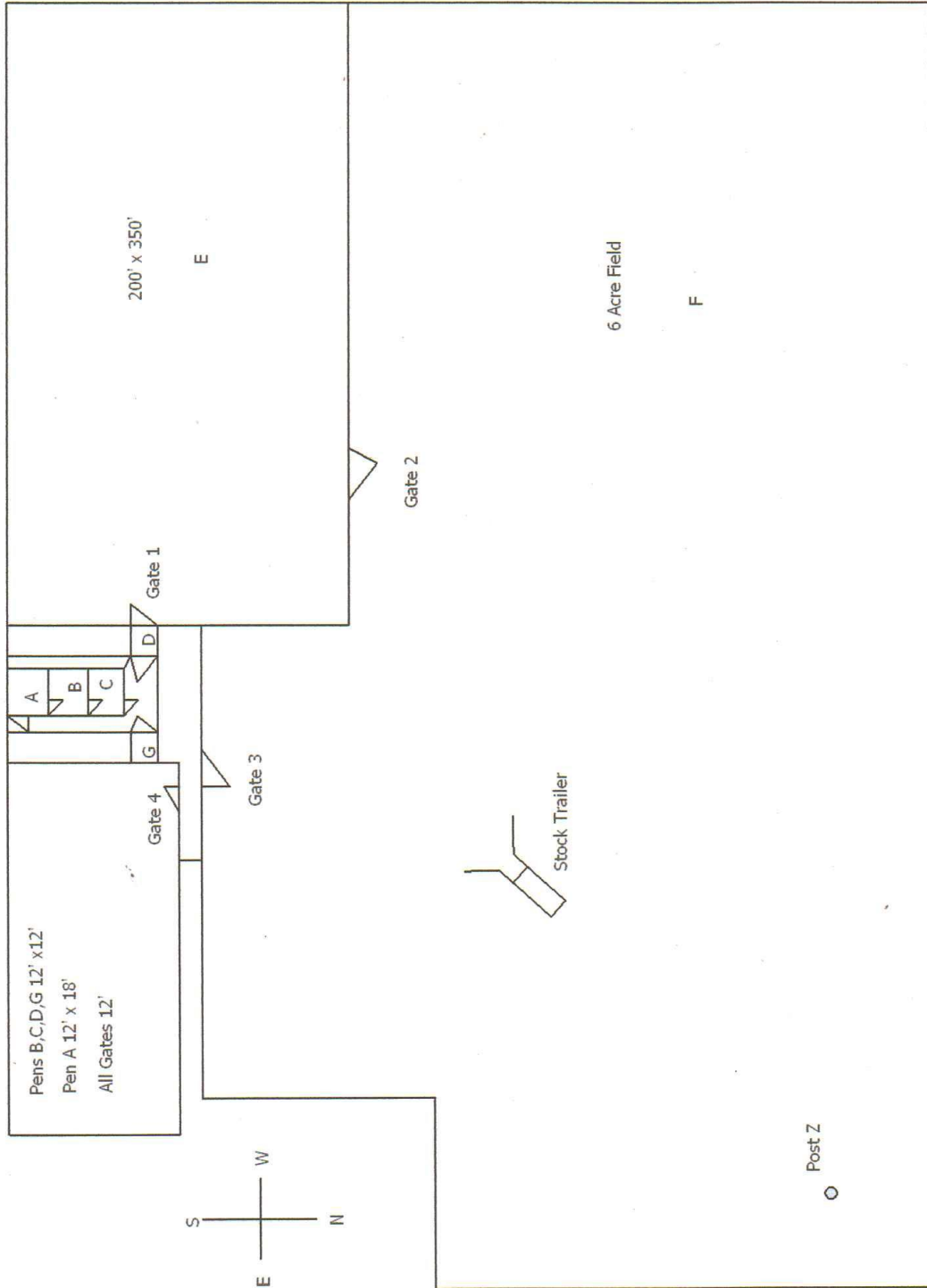





# Australian Shepherd Club of America® Stockdog Trial Entry Form

PLEASE PRINT OR TYPE ALL INFORMATION

ENTRY NUMBER
--------------

HOST CLUB
-----------

Breed \_\_\_\_\_ Color \_\_\_\_\_  
Registered \_\_\_\_\_  
Name of Dog \_\_\_\_\_  
Registration No. \_\_\_\_\_ Birth Date \_\_\_\_\_ Sex \_\_\_\_\_

MUST MARK CLASSES ENTERING FOR EACH DAY									
	Other Trial Date			Saturday Trial Date			Sunday Trial Date		
Circle divisions that apply									
Started	Ducks	Sheep	Cattle	Ducks	Sheep	Cattle	Ducks	Sheep	Cattle
Open	Ducks	Sheep	Cattle	Ducks	Sheep	Cattle	Ducks	Sheep	Cattle
Advanced	Ducks	Sheep	Cattle	Ducks	Sheep	Cattle	Ducks	Sheep	Cattle
Novice	Ducks	Sheep	Cattle	Ducks	Sheep	Cattle	Ducks	Sheep	Cattle
Working Jr. Handler	Ducks	Sheep	Cattle	Ducks	Sheep	Cattle	Ducks	Sheep	Cattle
Open Working Jr.	Ducks	Sheep	Cattle	Ducks	Sheep	Cattle	Ducks	Sheep	Cattle
Write in Division STD, OTD, ATD:									
For Exhibition Only	Ducks	Sheep	Cattle	Ducks	Sheep	Cattle	Ducks	Sheep	Cattle
Post Advanced		Sheep	Cattle		Sheep	Cattle		Sheep	Cattle
Ranch Trial		Sheep	Cattle		Sheep	Cattle		Sheep	Cattle
Farm Trial									
PLEASE PRINT OR TYPE ALL INFORMATION	TOTAL ENTRY FEES \$								

Junior's Relationship \_\_\_\_\_ JUNIOR  
to All Owners \_\_\_\_\_ Membership No. \_\_\_\_\_  
Junior's Name \_\_\_\_\_ Birth Date \_\_\_\_\_  
Sire \_\_\_\_\_  
Dam \_\_\_\_\_  
Breeder \_\_\_\_\_ Call Name \_\_\_\_\_  
ASCA  
Owner \_\_\_\_\_ Membership No. \_\_\_\_\_  
Address \_\_\_\_\_ E-Mail \_\_\_\_\_  
City/State/ZIP \_\_\_\_\_ Phone (\_\_\_\_) \_\_\_\_\_

Printed Name of Exhibitor \_\_\_\_\_ Date \_\_\_\_\_

**EXHIBITOR, OWNER or PARENT/LEGAL GUARDIAN (if Jr. is under 18)  
MUST READ and SIGN REVERSE SIDE of this FORM**

## AGREEMENT

THE PERSON WHO SIGNS THIS AGREEMENT REPRESENTS THAT SHE/HE IS AUTHORIZED TO ENTER INTO THIS AGREEMENT ON BEHALF OF BOTH EXHIBITOR AND THE OWNER OF THE ENTERED DOG. IN CONSIDERATION OF ACCEPTANCE OF THIS ENTRY:

- EXHIBITOR AND OWNER, WHETHER OR NOT MEMBERS OF ASCA®, WILL ABIDE BY THE RULES AND REGULATIONS OF THE AUSTRALIAN SHEPHERD CLUB OF AMERICA®, AND ANY OTHER RULES AND REGULATIONS APPEARING IN THE PREMIUM LIST FOR THIS EVENT.
- EXHIBITOR AND OWNER CERTIFY THAT THE ENTERED DOG IS NOT A HAZARD TO PERSONS, DOGS OR PROPERTY.
- EXHIBITOR AND OWNER ACKNOWLEDGE ALL HAZARDS PRESENTED BY THE EVENT AND THE EVENT PREMISES, INCLUDING, BUT NOT LIMITED TO, THE CONDITION OF THE FLOORS, STAIRWAYS, HALLS, LIGHTING, SECURITY MEASURES OR LACK THEREOF, ELECTRICAL APPLIANCES, SHOW RINGS, PARKING AREAS AND THE PRESENCE OF UNFAMILIAR ANIMALS AND PEOPLE; EXHIBITOR AND OWNER ASSUME THE RISK OF ANY HARM ARISING FROM THESE.
- EXHIBITOR AND OWNER RELEASE ASCA® AND WILL DEFEND ASCA® AND HOLD IT HARMLESS FROM ALL PRESENT AND FUTURE LOSS, INJURY, DAMAGE, CLAIMS, DEMANDS AND LIABILITIES INVOLVING THE ENTERED DOG, THE EVENT OR EVENT PREMISES.

FOR EXAMPLE, SHOULD THE ENTERED DOG INJURE STOCK, THE OWNER WILL PAY FOR VETERINARIAN SERVICES; IF THE INJURY IS SEVERE, OWNER WILL PAY THE MARKET VALUE OF THE STOCK.

\_\_\_\_\_  
**SIGNATURE OF OWNER, EXHIBITOR OR PARENT/  
LEGAL GUARDIAN (if a Junior is under 18 years of age)**

AS USED HERE, "ASCA®" MEANS THE OWNER AND THE OPERATOR OF THE EVENT PREMISES, THE AUSTRALIAN SHEPHERD CLUB OF AMERICA®, IT'S AFFILIATE CLUBS AND EACH OF THEIR MEMBERS, OFFICERS, DIRECTORS, EMPLOYEES, SHOW CHAIRMEN, SHOW COMMITTEES AND AGENTS.